



perfect precision. flawless function.

evolution



TECHNICAL BROCHURE



## our commitment to service

At Easylife Kitchens, we recognise our Clients as the cornerstone of our business. For this reason, we consider superior levels of client service to be more important than anything else - and we don't just say it, these are words we live by. The following are what we consider to be the minimum level of service you are entitled to:

### Communication

We undertake to ensure effective and constant communication between you and Easylife Kitchens.

- If you leave a telephonic message with us, we will return your call as soon as possible, but definitely before the end of the next working day.
- Once your project commences, we will keep you updated on a regular basis.
- You are entitled to speak to the owner of the business at any time if you are not satisfied with our service.

### Compliance

When you deal with Easylife Kitchens, you know that you are dealing with a reputable company. We are a member of the Kitchen Specialist Association (KSA) and we abide by their code of ethics. We are also a member of the Franchise Association of South Africa (FASA), your assurance that you are dealing with a credible franchise group.

### Competence

As the largest kitchen retail group, you can be certain that your project will be treated professionally and managed personally at all times by an expertly trained, highly skilled and creative designer, using state-of-the-art computer-aided design technology to conceptualise, design and customise your dream kitchen.

### Conduct

We pride ourselves on our professionalism, which is evident from the way we conduct ourselves:

- Our stores are owner-managed - giving you the best service is our top priority.
- We are committed to paying careful attention to everything we do.
- We undertake to be professional and courteous at all times.

### Choice

No two people have the same taste - why settle for limited choices? We have the widest range on offer, giving you everything you need to suit your individual requirements so you can select designs, finishes, extras and accessories to suit your budget.

### Convenience

As the largest retail kitchen group in South Africa, we have stores conveniently located nationwide. We specialise in all domestic storage solutions, from kitchens to built-in bedroom cupboards, to vanities, studies and bars, as well as accessories, appliances and almost anything else you may need for your project.

### Clarity

We are committed to being absolutely transparent with our costing. Detailed quotations are available, so that you will know exactly what you're paying for.

### Certainty

Our products offer superior quality, guaranteed. We are committed to using only first-grade materials. That's why our kitchen units have a two-year guarantee, and our hinges and runners have a lifetime guarantee. We manufacture all of our products locally. We have two modern, frequently upgraded factories based in Gauteng and the Western Cape. These factories are 100% dedicated to our franchises, ensuring the most efficient delivery of superior quality products at all times.

### Care

We strive to be socially responsible at all times.



2 Year Kitchen Guarantee

### Quality advantage

At Easylife Kitchens we do not compromise on quality and use only first-grade materials. Easylife Kitchens offer a two-year guarantee on materials and workmanship, and a lifetime guarantee on Blum hinges and runners.



### 1. Modern machinery

Easylife Kitchens factories are kept up-to-date with modern machinery and the latest manufacturing trends from around the world.



### 2. Assembly

Components are given a final inspection before being shipped to our customers countrywide.





3.



4.



5.



6.

### 3. CNC

Biesse CNC machining centres are used by Easylife Kitchens Manufacturing for high performance drilling and machining of all kitchen and built-in-cupboard components. They are ideal for providing flexible and reliable drilling solutions.

### 4. Factory

The Easylife Kitchens factories are equipped with the most up-to-date machinery in order to ensure consistent and reliable supply of quality products to our customers, whilst maximising efficiency and productivity.

### 5. Beam saw

Easylife Kitchens Manufacturing use Biesse Selco beam saws to ensure quality and accuracy of cutting, and provide reliable production capacity to meet peak season demand.

### 6. Staff

Skilled Easylife Kitchens machine operators are responsible for ensuring maximum output, using modern equipment and state-of-the-art technology.

### 7. Edge bander

Components are edged by Easylife Kitchens Manufacturing with Fraval or Biesse edgebanding technology for the application of different thicknesses of edging to particle board, using the hot-melt glue process.

### 8. Stock

Standard components are machined and merchandised, ready for final assembly and despatch.

### 9. Vehicles

The Easylife Kitchens fleet of vehicles ensure prompt delivery of orders to our valued customers.

### 10. Drawer assembly

Quality and accuracy are intrinsic to the Easylife Kitchens offer, continually striving for improvement to ensure customer satisfaction.



7.



8.



9.



10.

## quality advantage

At Easylife Kitchens we are proud of our seal of quality which carries a two-year product and workmanship guarantee. Our customers are assured of total peace of mind, secure in the knowledge that they are investing in a kitchen which has been designed in accordance with the latest computer-aided technology and manufactured to the highest quality standards, using only first-grade materials and components.

### Legs

We use imported virgin plastic adjustable carcass legs to ensure that the kitchen is protected from any possible flood damage.

### Sink bases

Imported aluminium trays are used to protect the kitchen cupboard under the sink from plumbing leaks.

### Aluminium worktop support brace for sink

Imported aluminium sink support braces are used to strengthen the worktop when a cut-out is made for a sink, which is usually positioned close to the edge of the worktop.

### Pre-drilling of holes on CNC

Specialised machines are used for pre-drilling holes to ensure accuracy, as well as minimising the handling of each component and for greater ease of assembly.

### Hinges with a lifetime guarantee

We use only Blum hinges, renowned for their high technology, outstanding quality and durability, with the additional option of self- or soft-closing cabinet doors.

### Drawers with a lifetime guarantee

Only Blum drawer systems are used, because of their unsurpassed, silent runners and effortless closing properties.

### Metal-sided drawers

Only Blum single drawer side systems are used, known for their high side stability and low sag values, instead of the wooden box option generally available on the market.

### 16mm drawer bases

These bases ensure strong, sturdy drawers that will withstand warping. In addition, as there is no grooving on the base, the carrying capacity of the drawers is increased.

### Soft-closing and handle-less option

As an alternative to normal drawer systems, we can upgrade your kitchen design to an integrated Blumotion soft-closing solution or even the further option of a handle-less kitchen.

### Adjustable shelves with pre-drilled holes

This manufacturing system allows our customers to choose their preferred location of shelves, together with the option of adding extra shelves.

### Pre-assemble each cupboard

In this way we ensure that the quality of each cupboard carcass is to standard, that all components required are in the flat pack (including hardware for assembly), and that everything is in place for final assembly on site.

### A-grade board

Only A-grade board is used in manufacture, which ensures that there are no colour variances in the Melamine, and that the quality of the board meets all industry standards regarding density of substrate and glue content.

### Hot-melt glue and state-of-the-art edge banding technology

This methodology provides for minimal visibility of the glue line and ensures long-lasting, smooth edging on all components.

## e<sup>volution</sup>

The Easylife Kitchens **e<sup>volution</sup>** is here, bringing you improved design and space-saving technology.

Easylife Kitchens is proud to showcase the latest European design trends incorporating space-saving wall and floor units. **e<sup>volution</sup>** covers every aspect of modern kitchen design, from deeper wall units, and floor units with standard drawers, pot drawers and internal drawers. This is contemporary European technology at its best, resulting in the perfect combination of space and mobility to maximise an efficient workflow in the kitchen.

**e<sup>volution</sup>** designs offer fantastic space-saving benefits. There are various configurations of drawer systems, such as the 6-tier drawer system which has 50% more drawer space. The wall units have 10% more cabinet depth for larger dinner plates, while the floor units make use of a smaller plinth, giving 10% more space inside the cabinet.

Visit one of our showrooms to view the **e<sup>volution</sup>**.

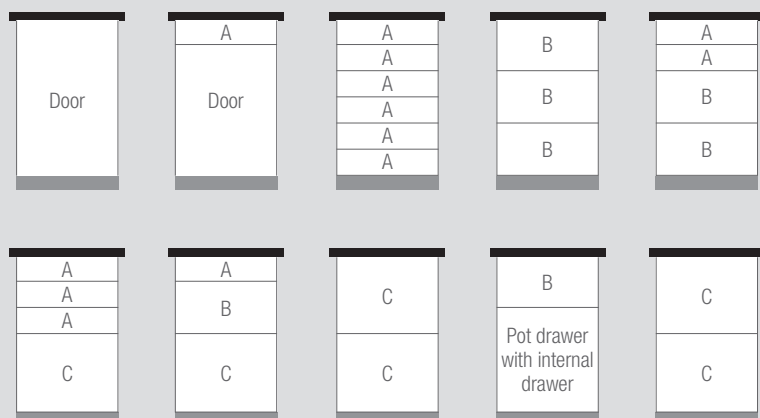

### Drawer configurations

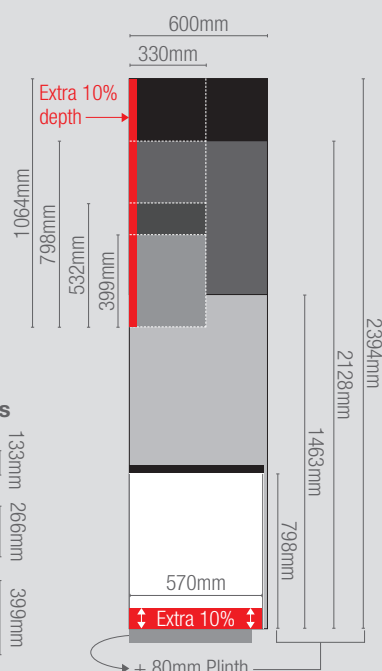
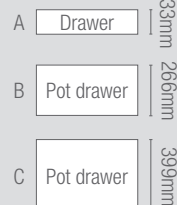



## Wall unit

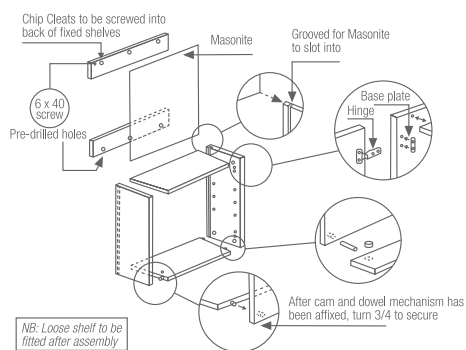
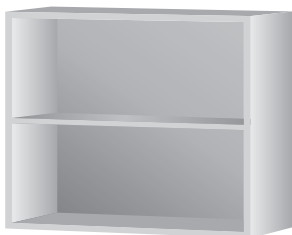

## Floor unit

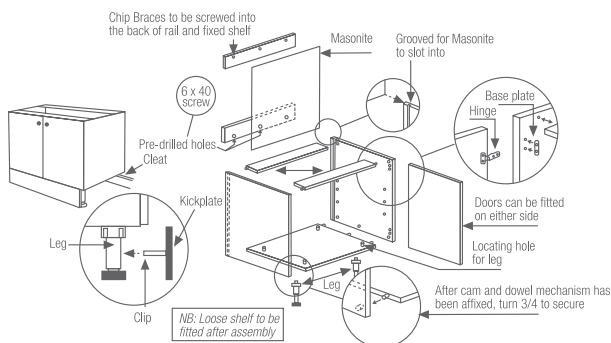
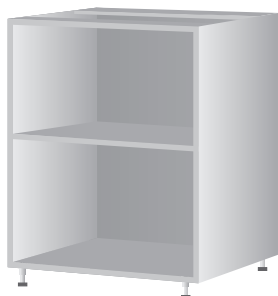

## Tall unit

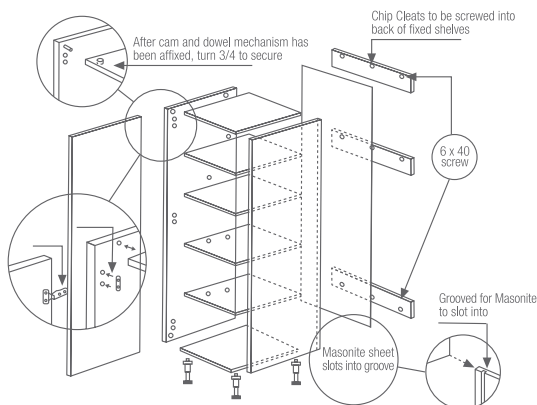
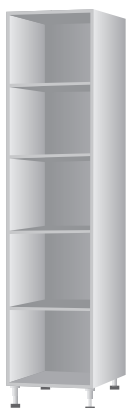

## Built-in cupboard

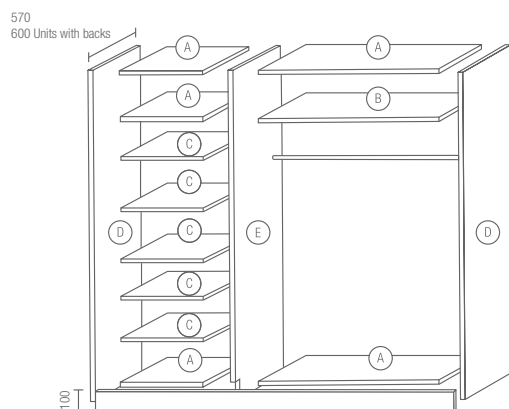
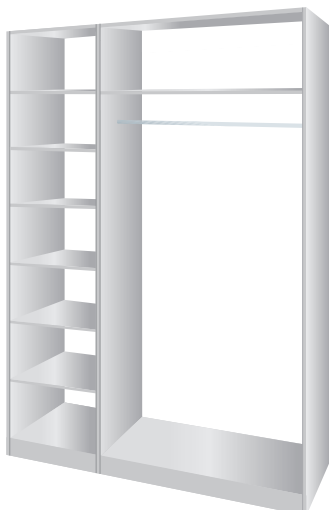

STANDARD COMPONENTS  
A = Fixed Shelf (MF)  
B = Fixed Shelf with Aluminium brace (MFA) - from 734  
Optional for BIC with backers  
C = Loose Shelf (M)  
D = Side (exposed or white)  
E = Division

## Wall units

Heights:	Widths:	Depths:
399mm	300mm	330mm
532mm	450mm	450mm
798mm	600mm	
1064mm	650mm	
1298mm	750mm	
1564mm	800mm	
	900mm	
	950mm	
	1000mm	

## Floor units

Heights:	Widths:	Depths:
798mm	150mm	570mm
plus	300mm	
80mm	450mm	
plinth	500mm	
	600mm	
	650mm	
	750mm	
	800mm	
	900mm	
	950mm	
	1000mm	
	1200mm	

## Tall units

Heights:	Widths:	Depths:
1463mm*	300mm	330mm
2128mm	450mm	450mm
2394mm	600mm	600mm
plus	650mm	
80mm	750mm	
plinth	900mm	

\* Tall boy unit

## Built-in cupboard standards

Heights:	Widths:	Depths:
2394mm	434mm	570mm
plus	484mm	
100mm	584mm	
plinth	734mm	
	784mm	
	884mm	
	984mm	
	1184mm	

## Built-in cupboard with backers

Heights:	Widths:	Depths:
2394mm	450mm	600mm
plus	500mm	
100mm	600mm	
plinth	750mm	
2660mm	800mm	
plus	900mm	
80mm	1000mm	
plinth	1200mm	

Customers come to Austro for an unparalleled range of world class manufacturing equipment for virtually any application.

Our business is built on 36 years of experience within the woodworking industry, and over the last decade that experience has been extended to customers in a variety of market sectors where we supply tooling, edging, and adhesives.

We work hard to understand our customers' production processes, operational environments, challenges, and opportunities by providing solutions that will keep them up-to-date and competitive.

## AUSTRO

MACHINES. TOOLING. EDGING. TECHNICAL SUPPORT



011 222 8300 | info@austro.co.za | www.austro.co.za

### Blanco

Mixer taps and sinks by BLANCO appeal for their excellent craftsmanship, first-class materials and unbeatable designs.

BLANCO has been producing high quality kitchen technology since 1925.



BLANCO

## FRANKE

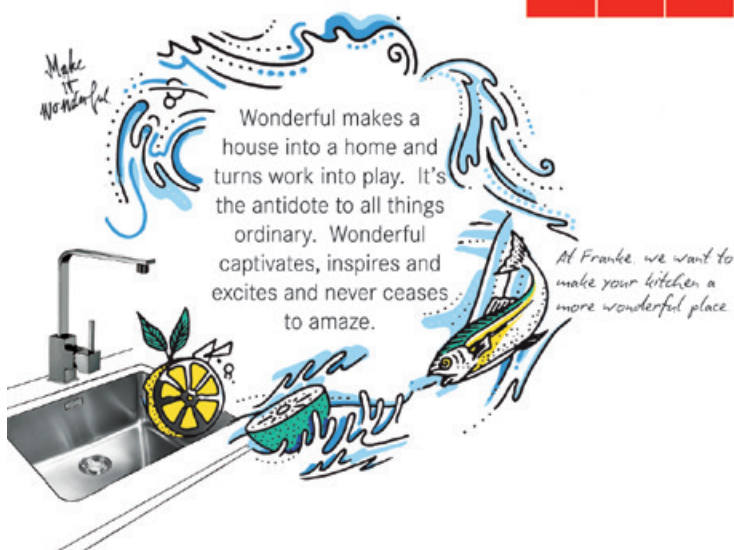

### Hailo

Hailo's built-in technology offers a multitude of optimum solutions for the kitchen industry.

Products range from built-in bins and waste separation systems right through to clever organisation systems for storage space.



Hailo

YOU WOULDN'T EXPECT  
SOMETHING SO BEAUTIFUL  
TO BE SO TOUGH

MELAWOOD  
SUPAGLOSS



MelaWood® SupaGloss™ is an amazing looking durable, UV hardened gloss surface that gives you the confidence of knowing you've made the right choice. Naturally, it's brought to you by PG Bison, the trusted name in decorative panels.

CUSTOMER SERVICE CENTRE: 0860 579 196  
www.pgbison.co.za

PG BISON

## SONAE ARAUCO

Taking wood further

Sonae-Arauco is a wood-based alliance between two strategic brands, namely Sonae Industria and Arauco.

We both share the same international growth ambition and long-term business vision. We both believe that everything we do is about people and a better planet. We both dream about a renewable and sustainable future.

Locally we have 2 fully automated and highly-engineered manufacturing plants with an established distribution network that operates nationally and into Africa, ensuring streamlined product delivery and top quality service.





## Blum

The Blum range includes high quality functional fittings, unique operating systems and space optimising solutions for cabinetry.

With unique BLUMOTION, drawers close softly and effortlessly.

Blum's DYNAMIC SPACE ideas will help to create your perfectly practical and beautiful kitchen.

All Blum hardware carries a guarantee for the lifetime of the furniture.



## Compusoft

Compusoft provides software solutions and services for kitchen and bathroom design.

We consider it our mission to create ever more measurable value for our customers, by integrating different software products as well as integrating products with services, thus generating a high return on investment for every customer.



## Kesseböhmer

From the elegance and functionality of LeMans to the space-saving style of Tandem, Kesseböhmer is turning the ordinary into the extraordinary.

Innovative designs with non-slip surfaces, transparent storage and smooth handling, deliver a level of simplicity that is easy to use. Everything in its perfect place. Everything within reach.



## National Edging

Proud suppliers of the highest quality ABS edging material to the ELK Group.

Matched perfectly to all new Melamine board designs in 1, 1.5 and 2mm thickness.

Flexible in any width required by deserving clients who only want the best.



## Teka

Our sinks are manufactured with the same meticulousness as a chef preparing his favourite recipe - by seeking the very best ingredients.

The finest steel, coupled with perfect design and functionality, make a Teka sink the silent centrepiece of your kitchen.



## Volpato

When we think of our products, we like to believe that they are never quite finished, but that they can further evolve and adapt themselves to our customers' requirements, as well as transforming and improving their technical and aesthetic aspect.

In fact, we think that the dynamism of our company comes from our ability to rework our products, creating new ones while paying special attention to the demands of the market.



# why choose Easylife Kitchens

## 10 reasons why you should choose Easylife Kitchens

### Peace of mind

We are members of the Kitchen Specialists Association (KSA) and the Franchise Association of South Africa (FASA).

### Convenient location

Well-appointed showrooms nationwide for the convenience of our customers.

### Design exclusivity

Our designers can assist you with the layout of your dream kitchen, using state-of-the-art computer-aided design technology.

### Locally manufactured products

Our two modern, constantly upgraded factories in Gauteng and Western Cape are dedicated to our franchisees.

### Care and attention

The person that owns the store runs the store. Giving you the best service is our top priority.

### Transparent costings

Fully itemised quotations are available, so you know exactly what you're getting, and what you're paying for.

### Quality guarantee

Only first-grade materials are used. Our kitchen units have a two-year guarantee, and our hinges and runners have a lifetime guarantee.

### Widest range

From the selection of designs and finishes, extras and accessories, you'll find everything you need right here.

### Branded appliances

We offer most makes of free-standing and integrated branded appliances, fixtures and fittings, for more quality assurance.

### All domestic storage solutions

Your one-stop-shop for kitchens, built-in cupboards, vanities, studies and bars.

## the Kitchen Specialists Association



### What is the Kitchen Specialists Association (KSA)?

The Kitchen Specialists Association (KSA) is a national association that represents reputable kitchen manufacturers and associated suppliers in South Africa, with a view to promoting growth and education within the industry and facilitating solution-driven resolutions between members and consumers.

Their mission is to create a professional, stable trading environment in which the industry can prosper and consumers can enjoy the reassurance and peace of mind that comes from dealing with reputable dealers.

### Why choose a registered KSA installer and supplier?

KSA members are committed to providing quality products by ensuring that the best quality materials are used for the price quoted. Consumers are assured of outstanding service before, during and after installation. If you were to encounter problems along the way and lodge a legitimate complaint with the KSA within one year of the date of purchase, the association will give you the necessary assistance and protection you require to resolve the situation.

### About the KSA and its members

There are two categories of KSA membership, namely ordinary and affiliate members. Ordinary members of the KSA are companies that manufacture and/or install kitchens. These companies are required

to offer their customers a minimum guarantee of one year on their product and installation. In addition, they must have a showroom where prospective customers can view the quality of product and installation that you can expect in your home.

Affiliate members of the KSA are companies that are affiliated to the kitchen industry by supplying a wide range of related products, including manufacturers and suppliers of boards, surfaces, sinks, taps, doors, handles, appliances, computer design software, etc.

All members have to adhere to the KSA's strict code of ethics, which covers manufacturing, installation and service standards. Members' references are screened thoroughly and they need to have been trading for a minimum of three years, and be registered in terms of South African law.

It is an acceptable standard for kitchen manufacturers and installers to request a 50% deposit on the signing of the contract, with a further 40% on the delivery of the carcasses to site, followed by the final 10% payment on completion of the work and signing off the job.

In the event of a dispute that requires intervention by the KSA, all members have signed an agreement to abide by any ruling handed down by the KSA, thereby providing consumers with total peace of mind.

We have showrooms nationwide, so you are never too far away from Easylife Kitchens.

0861 327 9543 / 0861 EASYLIFE [www.easylifekitchens.co.za](http://www.easylifekitchens.co.za)

Version: September 2017

Easylife kitchens are designed with practicality and integrity to suit your individual lifestyle.

